

CITY OF JENKS

211 NORTH ELM STREET • P.O. BOX 2007
JENKS, OKLAHOMA 74037-2007
PHONE (918) 299-5883 • FAX (918) 299-4489

NOTICE TO THE PUBLIC OF A HEARING ON A PROPOSED SPECIFIC USE PERMIT WITHIN THE CITY OF JENKS, OKLAHOMA

Zone Case JZ-606, Specific Use Permit 105 Amendment

Notice is hereby given that a public hearing will be held before the Jenks Planning Commission, in Jenks City Hall, Council Chambers, 211 North Elm Street, Jenks, Oklahoma, at 7:00 p.m. on the 14th day of September, 2017, in consideration of the proposed Specific Use Permit classification of property described as:

A tract of land located in the E/2 of Section 30, the W/2 of Section 29, the NE/4 of A tract of land located in the E/2 of Section 30, the W/2 of Section 29, the NE/4 of Section 31 and the NW/4 of Section 32 all in T18N, R13E of the Indian Meridian, Tulsa County, State of Oklahoma, according to the Official U.S. Government Survey thereof, being more particularly described as follows:

Beginning at a point of intersection of the south boundary of the Creek Turnpike Right of way and the ½ section line of Section 30, T18N R13 E; Thence South along the ½ Section Line of Section 30 to the SW Corner of the NE/4 of Section 30 T18N R13 E; Thence east along the South boundary of the said NE/4 to the east boundary of the Midland Valley Railroad Right of Way; Thence southward along the east boundary of the Midland Valley Railroad Right of Way to the south Section line of Section 30; Thence west along said the South Section line of Section 30 to the centerline of Polecat Creek; Thence eastward along the Centerline of Polecat Creek to the west bank of the Arkansas River; Thence continuing east to the centerline of the Arkansas River; Thence northward along the Centerline of the Arkansas River to a point of intersection with the South boundary of the Creek Turnpike Right of Way, this description of the centerline to follow the jurisdictional boundary as outlined in City of Jenks Ordinance 1220 annexing to the centerline of the Arkansas River; Thence West along the South Boundary of the Creek Turnpike Right of Way to the Point of Beginning.

General Location: 7th Street South and East 101st Street South

Zone Case JZ-606 Specific Use Permit 105 Amended is a request by Anchor Stone Company to Amend the approved Specific Use Permit (SUP No. 105) to allow excavated sand and gravel to be transported using the turnpike frontage roads instead of requiring to the use of dredge vehicles in the river only to the Delaware Sand Plant located at 115th and Delaware.

All persons interested in this matter may appear at these hearings and present their objections to or arguments for any and all of the above matters.

In the event that such proposed amendment is approved, in the whole or in part, by the Jenks Planning Commission, said Planning Commission shall submit its recommendations to the City Council of the City of Jenks, for its consideration and action as approved by law.

Dated at Jenks Oklahoma this 9th day of August 2017.

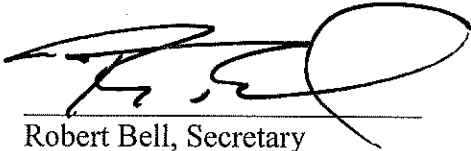
A handwritten signature in black ink, appearing to read 'R. Bell', written over a horizontal line.

Robert Bell, Secretary
Jenks Planning Commission

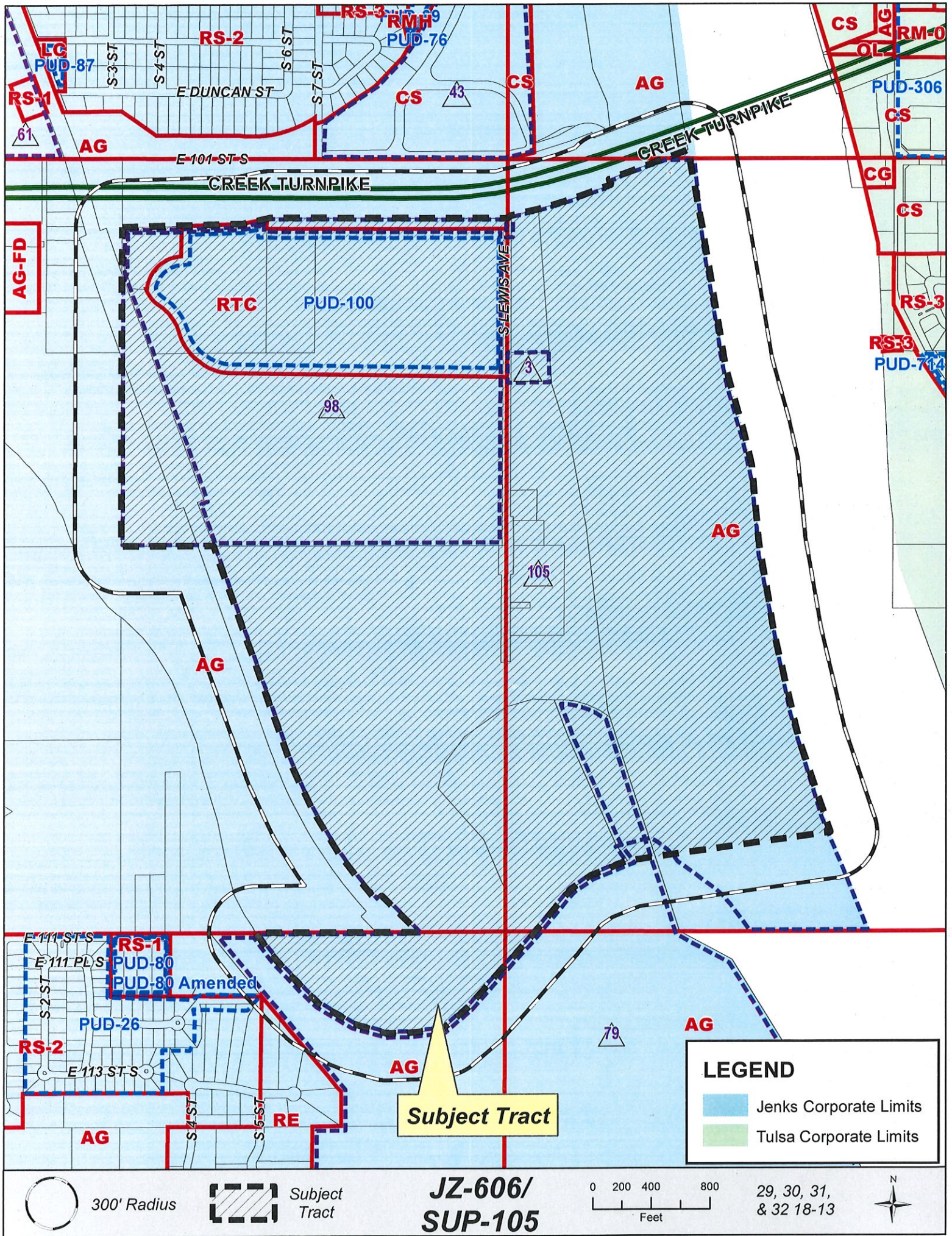

Subject Tract

LEGEND

- Jenks Corporate Limits
- Tulsa Corporate Limits

300' Radius

Subject Tract

**JZ-606/
SUP-105**

0 200 400 800
Feet

29, 30, 31,
& 32 18-13

