

## CITY OF JENKS

211 NORTH ELM STREET • P.O. BOX 2007  
JENKS, OKLAHOMA 74037-2007  
PHONE (918) 299-5883 • FAX (918) 299-4489

### NOTICE OF A PUBLIC HEARING LOCATED IN THE CITY OF JENKS, OKLAHOMA

**Case Number:** JZ 23 PUD 137

**Request:** Planned Unit Development

Request by Inspiration Hall, LLC for a Planned Unit Development to allow for a food hall.

**Legal Description:** Lot Two (2), in Block One (1), OKLAHOMA AQUARIUM CAMPUS, an Addition to the City of Jenks, Tulsa County, State of Oklahoma, according to the recorded Plat No. 6114, LESS AND EXCEPT a tract described as follows: Beginning at a Point that is the Northeast Corner of Lot Three (3), Block One (1), of said OKLAHOMA AQUARIUM CAMPUS, said point also being the most Northerly Northwest Corner of said Lot Two (2); THENCE North  $67^{\circ} 14'12''$  East along a Northerly line of said Lot Two (2) for 72.32 feet to the Northerly Northeast Corner of said Lot Two (2); THENCE South  $18^{\circ}08'45''$  East along the Easterly line of Lot Two (2) for 111.24 feet; THENCE South  $3^{\circ}29'15''$  East along the Easterly line of Lot Two (2) for 75.00 feet; THENCE South  $24^{\circ} 52'29''$  West along the Easterly line of Lot Two (2) for 50.00 feet; THENCE South  $17^{\circ} 21 '56''$  East along the Easterly line of Lot Two (2) for 86.10 feet; THENCE South  $55^{\circ}27'37''$  West for 51.56 feet to the Southeast Corner of said Lot Three (3); THENCE North  $12^{\circ} 24'53''$  West along the Easterly line of Lot Three (3) and along a Westerly line of Lot Two (2) for 316. 76 feet to the Point of Beginning of said tract of land.

**General Location:** North of Oklahoma Aquarium

**Hearing Date:** 19 January 2023

**Location:** Jenks City Hall, 211 N Elm St, Jenks, OK 74037

All persons interested in this matter may appear at these hearings and present their objections to or arguments for any of the above matters.

Dated at Jenks Oklahoma on 5 December 2022.

Marcae Hilton, Secretary  
Jenks Planning Commission

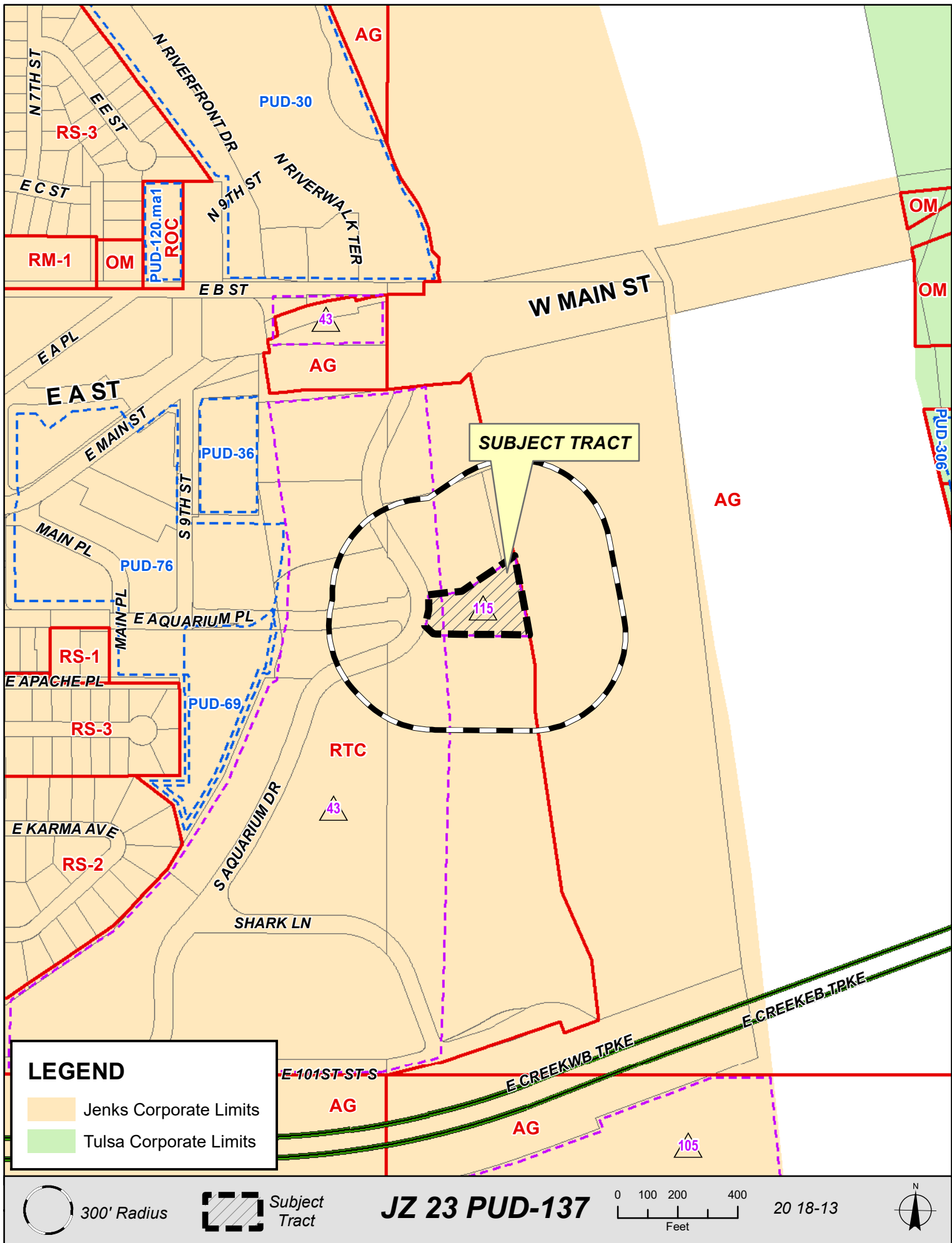

**LEGEND**

- Jenks Corporate Limits
- Tulsa Corporate Limits



**JZ 23 PUD-137**

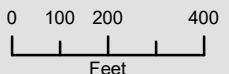

20 18-13

